

The Red Head Brass Commitment to Quality and Safety in Storz Couplings

Red Head's high quality Storz couplings have no peer. Our Storz heads are forged as required by the DIN standards for firefighting applications...not cast. The tail pieces are made from extruded aluminum...not castings or plastics. Collars are made from high strength aluminum extrusions...not cast. Review our quality below, and then insist on the best, Storz couplings from Red Head Brass.

Tail piece and collars made from 6061-T6 aluminum seamless extrusions.

Meets *ASTM B221*.

NO CAST OR PLASTIC TAILS OR COLLARS!!

All Storz Heads are *forged* 6061-T6 aluminum to *Spec. SAE-AMS-QQ-A-367* and *ASTM B247*.

Complies with *DIN standards*.
NO CAST STORZ HEADS!!

Stainless Steel Lock Lever assembly configuration:

Lock Lever is an *investment casting* of 304 stainless steel *ASTM A743*.

Lock Lever Spring is 316 stainless wire passivated *AISI 316*.

Lock lever mounted with 18-8 stainless steel shoulder bolt.

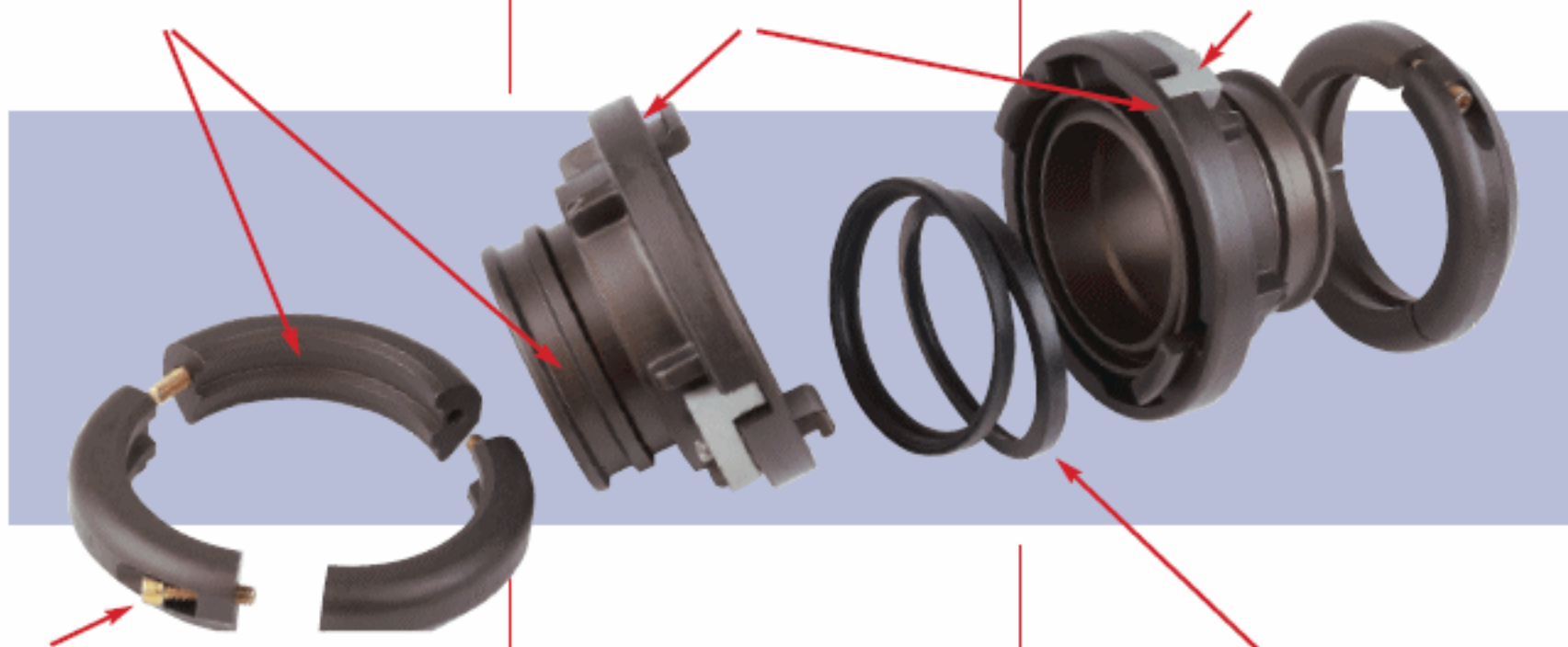

Collars are assembled with $\frac{3}{8}$ -16 socket head cap screw made of a high tensile alloy to *ASTM A574* with Zinc Yellow Dichromate coating to *QQ-Z-325, Type II*.

All aluminum components are *Hardcoat Anodized* per *MIL-A-8625 Type III, Class 1*.

High quality molded Storz gaskets made using *Buna-N material*. This material is resistant to most hydrocarbons, oils, gasoline, acids, and greases.

RED HEAD SPECIFICATIONS: Aluminum Storz Hose Couplings shall consist of Storz coupling heads machined from forged 6061-T6 aluminum and coupling components fabricated from seamless extruded 6061-T6 aluminum. All aluminum components shall be hardcoat anodized per MIL-A-8625 Type III, Class 1. Part identification shall be permanent and stamped or forged prior to hardcoat. All 4", 5", and 6" adapters shall include a stainless steel external spring-loaded lock. Storz gaskets shall be molded Buna-N rubber.

For field reattachable couplings add: The couplings shall have a tail piece sized to match hose diameter and matching segmented, bolted clamp collars fabricated from seamless extruded 6061-T6 aluminum. Couplings and components must meet the requirements of NFPA 1963.

For expansion type couplings add: Swivel and tail gaskets shall be lathe cut ozone free EPDM or synthetic rubber. Expansion rings must be smooth and well rounded soft anneal seamless red brass per UNS 23000. Couplings and components must meet the requirements of NFPA 1963.